

# Multi-Mode Coupler

## Features:

- Low Insertion Loss
- Broad Operating Wavelength
- High Directivity
- Telcordia Compliance
- Excellent Environmental & Mechanical Stability

## Applications:

- Local Area Networks
- Gigabit Ethernet
- Subscriber Loop
- Fiber Optic Instruments and Sensors



## Specifications<sup>1</sup>:

Parameter	Unit	Grade "A"
Wavelength Range	nm	600~1600
Central Wavelength ( $\lambda_c$ )	nm	850 or 1310
Coupling Ratio <sup>2</sup>	%	50/50
Excess Loss	Max. dB	0.8
Insertion Loss	Max. dB	3.9
Uniformity	Max. dB	0.6
Return Loss	Max. dB	40
Directivity	Min. dB	40
Fiber Length	Min. m	1.0 meter, or on request
Fiber Type	Multimode 50/125 $\mu$ m, 62.5/125 $\mu$ m fiber	
Operating Temperature	°C	0~70
Storage Temperature	°C	- 40~85
Package	mm	1: 250 $\mu$ m bare fiber: 3.0 × 48 2: 900 $\mu$ m loose tube: 3.5 × 66 3: 2mm cable: 90×16×9 (L×W×H) 4: 3mm cable: 90×16×9 (L×W×H)

1. Values referenced without connectors.

2. Other coupling ratios is also available.

**Dimension:**

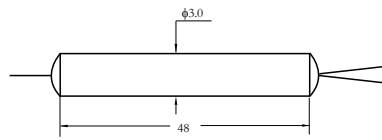

Figure 1. Package for 250 μm fiber

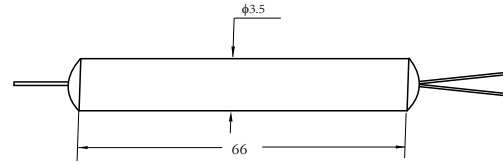

Figure 2. Package for 900 μm fiber

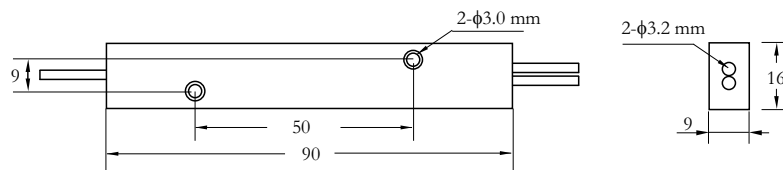

Figure 3. Package for 3mm Cable

**Order Information:**

MMWC -  $\frac{X}{\text{A}}$  -  $\frac{XXX}{\text{B}}$  -  $\frac{XXX}{\text{C}}$  -  $\frac{XX}{\text{D}}$  -  $\frac{XXX}{\text{E}}$  -  $\frac{XX}{\text{F}}$  -  $\frac{X}{\text{G}}$

A	Grade	A=Grade "A"
B	Central Wavelength	850=850 nm 1310=1310 nm
C	Fiber Type	050=50/125 μm 062=62.5/125 μm
D	Package Type	1=Package 1 2=Package 2 3=Package 3 4=Package 4
E	Type	1×2=1 × 2 2×2=2 × 2
F	Tap Ratio	50=50/50
G	Connector	N=W/O connector Y=With connector <sup>1</sup>

1. Please specify the type of connector when ordering if connector is required.