

# Single Mode WDM Couplers

## Features:

- High Reliability
- Ultra Low Pump Loss
- Ultra Low PDL
- High Isolation
- Excellent Environmental & Mechanical Stability



## Applications:

- Telecommunications
- Fiber Optical Amplifier
- WDM System

## Specifications<sup>1</sup>:

Parameter	Unit		Grade "A"		
Central Wavelength ( $\lambda_c$ )		nm	1310/1550	1480/1550	980/1550
Bandwidth		nm	+/- 15	+/- 5	+/- 15
Type		%	1x2 or 2x2		
Insertion	Min.	dB	17	16	20
	Max.				
Insertion Loss ( $\lambda_c$ , 23°C)	Max.	dB	0.20	0.25	0.15
Directivity	Min.	dB	60		
PDL	Max.	dB	0.1		
Thermal Stability	Max.	dB/°C	0.002		
Fiber Type			Corning SMF-28	Corning SMF-28	OFS 980
Fiber Length		m	1.0, or customer on request		
Operating Temperature		°C	0~70		
Storage Temperature		°C	- 40~85		
Package	250 $\mu$ m bare fiber	mm	1: Dia. 3.0x52	2: Dia. 3.0x60	3: Dia. 3.0x40
	900 $\mu$ m loose tube		4: Dia. 3.5x70	4: Dia. 3.5x70	5: Dia. 3.5x66
	3 mm cable		6: 90x16x9	6: 90x16x9	6: 90x16x9

1. Values referenced without connectors.

**Dimension:**

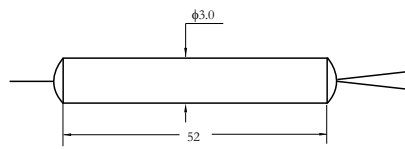

Figure 1. Package for 250 μm fiber

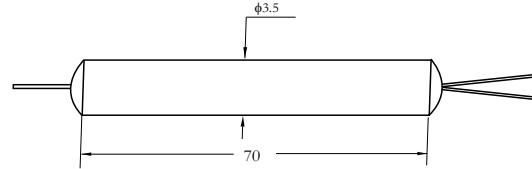

Figure 2. Package for 900 μm fiber

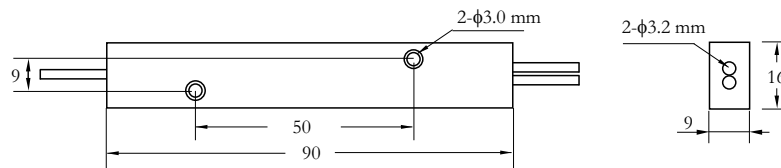

Figure 3. Package for 3mm Cable

**Order Information:**

SWDC - X - XXXX - XXXX - X - X - X  
 A B C D E F

A	Grade	A=Grade "A" S=Custom
B	Central Wavelength	1315=1310 & 1550 nm 1415=1480 & 1550 nm 9815=980 & 1550 nm
C	Fiber Type	250S=250 μm bare fiber 900L=900 μm loose tube 2000=2 mm cable 3000=3 mm cable
D	Type	1×2=1 × 2 2×2=2 × 2
E	Package Type	1=Package 1 ⋮ 6=Package 6
F	Connector	N=W/O connector Y=With connector <sup>1</sup>

1. Please specify the type of connector when ordering if connector is required.